



**CIMAT'10**  
CAMBODIA INTERNATIONAL MANUFACTURING TECHNOLOGY EXHIBITION  
21 - 23 OCTOBER 2010 - PHNOM PENH - CAMBODIA

**CIMAT 2010 in Phnom Penh**

The City of Phnom Penh will host Cambodia's 1st International Manufacturing Technology Exhibition - CIMAT 2010 at the new Diamond Island exhibition centre from 21 to 23 October, 2010.

The manufacturing sector is growing at a rapid pace over the past few years and reached 12% in 2007. The nation's GDP averaged 11% from 2004-7 lead by foreign investments and increasing local consumption. In spite of the slowing global economy, Cambodia's growth registered 7.5% in 2008. The economic growth is projected to register positive growth in 2009-2010 and will reach 7% in 2011. Manufacturing FDI amounted to 43 percent of total FDI in Cambodia. From 1994 to 2004, the manufacturing sector contributed, on average, more than 70 percent to the total industrial output (Ministry of Planning, 2006).

Over the last decade, manufacturing contribution to economic output in Cambodia has increased from 10 percent to around 30 percent today. It's time to position your organisation to capitalise on this growth and capture your market share at CIMAT 2010. It is the platform to showcase the complete range of machinery and technology for the manufacturing sector. CIMAT 2010 Expo is the business to business event that will deliver to you targeted buyers looking for new manufacturing machinery, technology and equipment.

<b>Venue</b>	Diamond Island Convention & Exhibition Center
<b>Organizers</b>	<ul style="list-style-type: none"> <li>• AMB Events Sdn Bhd</li> <li>• MEREBO Messe Marketing (in charge for the European &amp; North American Pavilion)</li> </ul>
<b>Scope of Exhibits</b>	Factory Automation Food & Drinks Processing Machinery Garment/Textile Machinery Industrial Equipments/Tools Industrial Safety Equipment Material Handling / Factory Storage Systems Metalworking/Machinetools Packaging Machinery Plastics Machinery Printing Machinery Welding Technology etc.

**The Participation**

That's MEREBO: All inclusive! The main attention of MEREBO is to provide you with full service and high standards to simplify your participation as much as possible. Our renowned partners for freight forwarding, individual stand design, travel, accommodation, etc. will also support you.

MEREBO and partners are always available on-site to ensure a smooth show process for you and your company.

**Participation Costs**
**Full Package Stands within the Pavilions**
**Space only (EUR per m<sup>2</sup>)**

9 m <sup>2</sup> Row Stand	EUR 2850	Row Stand	EUR 235
18 m <sup>2</sup> Row Stand	EUR 5650	Corner Stand	EUR 240
27 m <sup>2</sup> Row Stand	EUR 8400	Head Stand	EUR 245
36 m <sup>2</sup> Head Stand	EUR 10900	Island Stand	EUR 250

Up to **6% Early Bird Discount** available until 31 March, 2010 (please refer to the Application Form)!

**Details of the Full Package Stands**

The Full Package Stands contain all necessary items of a high quality stand construction. They enable an attractive presentation of your company. Additional items such as machinery power connections, water supplies, show cases, kitchen units or any other special requirement can be ordered as well. Please refer to the attached stand layouts for all details.

**Full Package Stands contain:**

- Exhibition space
- Stand construction in Octanorm System
- Carpet (selection of different colours)
- Company name and country on the fascia panel
- Lockable storage room
- 1 Power socket 13A / 220V
- 1 Paper basket
- 1 Wall coat hanger
- 3 spotlights each 9 m<sup>2</sup>
- Information counter (9 und 18 m<sup>2</sup>: 1 St, 27 und 36 m<sup>2</sup>: 2 St.)
- Table (9 m<sup>2</sup> and 18 m<sup>2</sup>: 1 pc., 27 m<sup>2</sup> and 36 m<sup>2</sup>: 2 pcs.)
- Leather chairs (9 m<sup>2</sup>: 4, 18 m<sup>2</sup>: 6, 27 and 36 m<sup>2</sup>: 8)
- 3 Exhibitor Badges each 9 m<sup>2</sup>
- 30 Visitor Invitation Tickets each 9 m<sup>2</sup>
- Daily stand cleaning
- Listing in the Catalogue

**The Venue**

CIMAT 2010 will take place at Diamond Island Convention & Exhibition Center in Phnom Penh. The venue is a newly completed centre located in the centre and close to all major hotels and attractions. All halls are fitted with independent air-cooling systems. It also provides other supporting facilities including seminar rooms, cafes, restaurants, VIP rooms, internet lines and high-tech security system.

**Phnom Penh**

Phnom Penh is the capital of Cambodia, situated in the southwest of the country at the Tonle Sap – a feeder of the Mekong. Smaller seagoing vessels can reach the city through the Mekong.

Ten km away from the city centre is the international airport of Phnom Penh, by whom you can reach the city several times a day via Bangkok, Singapore, Hong Kong, Kuala Lumpur etc.

**Cambodia**

The Kingdom of Cambodia is a country in South East Asia with a population of over 14 million people. It is situated in the Gulf of Thailand. The country borders Thailand to its west and northwest, Laos to its northeast and Vietnam to its east and southeast. The geography of Cambodia is dominated by the Mekong River and the Tonle Sap - lake, an important source of fish.

The economy of Cambodia has seen rapid progress in the last decade. Agriculture has long been the most important sector of the Cambodian economy, with around 59% of the population relying on agriculture for their livelihood. Garments, tourism and construction are also important. In 2008 more than 2 Million tourists came to Cambodia. In 2005, oil and natural gas deposits were found beneath Cambodia's territorial waters, and once commercial extraction begins in 2011, the oil revenues could profoundly affect Cambodia's economy.

**Concurrently held with CIMAT 2010**

**CamBuild 2010** - Cambodia International Building & Construction Industry Show

**CamHotel 2010** - Cambodia International Hotel, Restaurant & Catering Show

**CamFood 2010** - Cambodia International Food & Drinks Industry Show

**CamSecurity 2010** - Cambodia International Security, Safety & Fire Show

**CamFire 2010** - Cambodia International Fire Protection & Rescue Show

**Websites**

Please also visit our Cambodian trade shows in the Internet



**[www.cambododia.merebo.com](http://www.cambododia.merebo.com)**

**Contact**

**MEREBO Messe Marketing**

Jakobikirchhof 9  
 20095 Hamburg  
 GERMANY  
 Phone: +49-40-3999905-0  
 Fax: +49-40-3999905-25  
 E-mail: [contact@merebo.com](mailto:contact@merebo.com)  
 Web: [www.merebo.com](http://www.merebo.com)

**AMB EVENTS SDN BHD**

Suite 1701, 17th Floor Plaza Permata ( IGB Plaza )  
 6, Jalan Kampar, Off Jalan Tun Razak,  
 50400 Kuala Lumpur  
 MALAYSIA  
 Phone: +603-40454993  
 Fax: +603-40454989  
 E-mail: [richard@ambexpo.com](mailto:richard@ambexpo.com)  
 Web: [www.ambexpo.com](http://www.ambexpo.com)

## 9 m<sup>2</sup>

Exhibition space of 3m x 3m including:

Stand construction in Octanorm system, carpet (selection of different colours), company name in Latin characters on fascia panel, 3 spotlights, 1 table 70 x 70 cm, 4 leather chairs, 1 information counter, 0.5 m<sup>2</sup> storage room with lockable folding door, 220V power socket, paper basket, wall coat hanger, daily stand cleaning

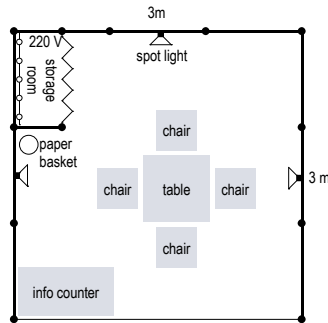

## 18 m<sup>2</sup>

Exhibition space of 6m x 3m including:

Stand construction in Octanorm system, carpet (selection of different colours), company name in Latin characters on fascia panel, 6 spotlights, 1 table 120 x 70 cm, 6 leather chairs, 1 information counter, 1 m<sup>2</sup> storage room with lockable folding door, 220V power socket, paper basket, wall coat hanger, daily stand cleaning

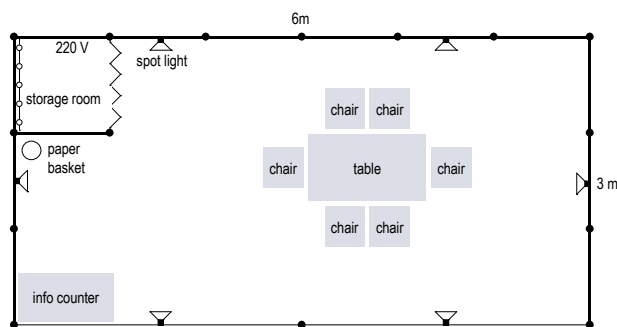

## 27 m<sup>2</sup>

Exhibition space of 9m x 3m including:

Stand construction in Octanorm system, carpet, company name in Latin characters on fascia panel, 9 spotlights, 2 tables 70 x 70 cm, 8 leather chairs, 2 information counters, 1 m<sup>2</sup> storage room with lockable folding door, 2 no. of 220V power socket, paper basket, wall coat hanger, daily stand cleaning

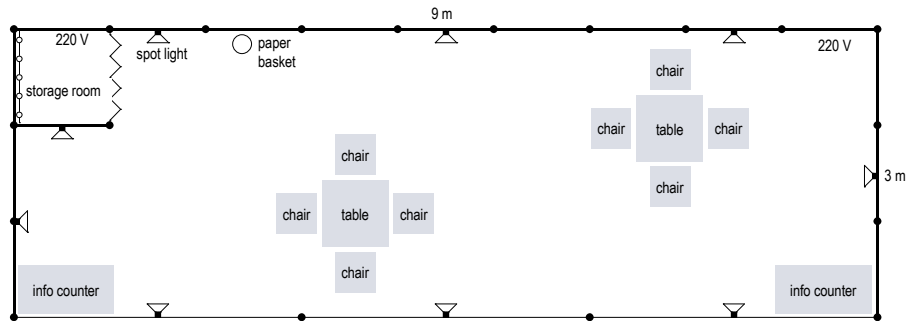

## 36 m<sup>2</sup>

Exhibition space of 6m x 6m including:

Stand construction in Octanorm system, carpet, company name in Latin characters on fascia panel, 12 spotlights, 2 tables 70 x 70 cm, 8 leather chairs, 2 information counters, 5 m<sup>2</sup> meeting room with lockable door, 1 m<sup>2</sup> storage room with lockable folding door, 2 no. of 220V power socket, paper basket, wall coat hanger, daily stand cleaning

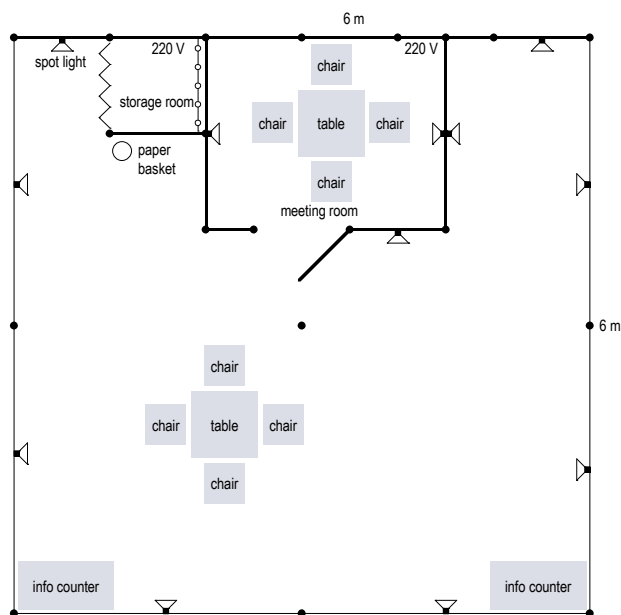

# Application Contract CIMAT 2010

Cambodia International Manufacturing Technology Show  
21 - 23 October, 2010  
Phnom Penh, Cambodia  
Diamond Convention & Exhibition Center  
Application Deadline: 21st of August, 2010  
Early Bird Discount valid until 31st of March, 2010

**MEREBO**  
MEREBO Messe Marketing  
Jakobikirchhof 9  
20095 Hamburg  
Germany  
Tel. +49-40-3999905-0  
Fax +49-40-3999905-25  
E-mail contact@merebo.com

## Exhibitor

Company	<input type="text"/>		
Address 1	<input type="text"/>		
Address 2	<input type="text"/>		
Telephone	<input type="text"/>	Fax	<input type="text"/>
E-mail	<input type="text"/>	VAT no.	<input type="text"/>
Contact Person	<input type="text"/>		

## Full Package Stands (please tick your choice)

Stand Size	Dimensions		Normal Rate	Early Bird Rate
9 m <sup>2</sup> Row Stand	3 m x 3 m	<input type="checkbox"/>	EUR 2850	EUR 2700
18 m <sup>2</sup> Row Stand	6 m x 3 m	<input type="checkbox"/>	EUR 5650	EUR 5350
27 m <sup>2</sup> Row Stand	9 m x 3 m	<input type="checkbox"/>	EUR 8400	EUR 8000
36 m <sup>2</sup> Head Stand	6 m x 6 m	<input type="checkbox"/>	EUR 10900	EUR 10400
<input type="checkbox"/> <b>Corner Stand</b>	Surcharge of EUR 200 for 18 m <sup>2</sup> and 27 m <sup>2</sup> (not available for 9 m <sup>2</sup> )			
<input type="checkbox"/> <b>Head Stand</b>	Surcharge of EUR 300 for 18 m <sup>2</sup> (not available for 9 m <sup>2</sup> and 27 m <sup>2</sup> )			

**Including:** Raw space, registration fee, exhibitor badges, 30 invitation tickets each 9 m<sup>2</sup>, catalogue entry with company description, special discount rates for several official hotels.

**Stand construction** in Octanorm System, carpet, company name on fascia board, lockable storage room (9 m<sup>2</sup>: 0,5 m<sup>2</sup>, 18 and more m<sup>2</sup>: 1 m<sup>2</sup>), information counter (27 and 36 m<sup>2</sup>: 2), table 70 x 70 cm (18 m<sup>2</sup>: 120 x 70 cm, 27 m<sup>2</sup>: 2 tables), 4 leather chairs (18 m<sup>2</sup>: 6, 27 m<sup>2</sup>: 8), paper basket, wall coat hanger, 3 spotlights (100W) each 9 m<sup>2</sup>, power socket 13A / 220V, daily stand cleaning.

**36 m<sup>2</sup> stands additionally:** meeting room (5 m<sup>2</sup> with 4 leather chairs and 1 table of 70 x 70 cm).

## Space only (please tick your choice)

m<sup>2</sup> with own stand construction

	Stand Size		Normal Rate	Early Bird Rate
Row stand (1 side open)	min. 36 m <sup>2</sup>	<input type="checkbox"/>	EUR 235 / m <sup>2</sup>	EUR 225 / m <sup>2</sup>
Corner stand (2 sides open)	min. 36 m <sup>2</sup>	<input type="checkbox"/>	EUR 240 / m <sup>2</sup>	EUR 230 / m <sup>2</sup>
Head stand (3 sides open)	min. 72 m <sup>2</sup>	<input type="checkbox"/>	EUR 245 / m <sup>2</sup>	EUR 235 / m <sup>2</sup>
Island stand (4 sides open)	min. 72 m <sup>2</sup>	<input type="checkbox"/>	EUR 250 / m <sup>2</sup>	EUR 240 / m <sup>2</sup>

**Including:** Raw space, registration fee, exhibitor badges, 50 invitation tickets, catalogue entry with company description, special discount rates for the official hotels.

<input type="text"/>	<input type="text"/>	<input type="text"/>
Place & Date	Name	Authorised signature

The Participation Terms are recognized as legally binding in all parts. ([www.merebo.com/Terms](http://www.merebo.com/Terms))  
Terms of Payment: 25% of total charges to be paid immediately upon receipt of the invoice. 25% by 31st of March, 2010.  
Remaining balance to be remitted before 21st of July, 2010.

**Please return by fax to +49-40-3999905-25**

## **Terms of participation**

### **1. Application to participate in the exhibition**

Applications are to be made on the enclosed form, which should be returned to MEREBO Messe Marketing at the earliest opportunity, filled in and signed with a legally binding signature. The rental contract comes into force once MEREBO Messe Marketing has informed the applicant in writing that he is admitted.

The exhibitors shall not be entitled to withdraw from the exhibition after admission. Notice of withdrawal shall be made in writing to the MEREBO Messe Marketing, and shall take effect only when written consent is given by MEREBO Messe Marketing and the exhibitor agrees to pay compensation in accordance with the sliding scale that follows. The cancellation charge is calculated as a proportion of the participation fee, depending on how long before the start of the event the withdrawal is received: 1. 6 months or more 25%, between 4 and 6 months 50%, between 0 and 4 months 100%.

MEREBO Messe Marketing is entitled to rescind the application contract or to terminate the application contract if the exhibitor opens insolvency proceedings or bankruptcy proceedings or if the company of the exhibitor goes into liquidation. However the full participation fees must be paid.

### **2. Participation fees and terms of payment**

The participation fees are calculated in accordance with the clauses set out in the application form. The fee to be paid by the exhibitor to MEREBO Messe Marketing includes the rent for the space as well as the wide range of services offered by MEREBO Messe Marketing. The deadlines for payment given in the application form or the invoice must be observed. If the stand is allocated within 90 days of the start of the fair, then the full amount is due immediately. If the terms of payment are not met by the exhibitor, MEREBO Messe Marketing reserves the right to cancel the application. If the application is cancelled, the exhibitor is liable for 50% of the participation fees. In case of cancellation within 90 days before the exhibition begins, the full participation fees must be paid.

### **3. Co-exhibitors and additionally represented organisations**

Co-exhibitors and additionally represented organisations must be applied for separately in writing, together with the application for the main exhibitor, and specifying their full addresses.

### **4. Cancellation or curtailment of the exhibition**

MEREBO Messe Marketing shall not be required to refund the participation fees or any part thereof to the exhibitor or be liable for any loss or damage suffered by the exhibitor in the event that the exhibition is cancelled or suspended or the duration of the exhibition is reduced owing to such circumstances beyond MEREBO Messe Marketing's control as may be: - outbreak of war or civil unrest - orders of governmental or statutory authorities - fire, floods and other acts of God strikes by workmen; lockouts.

### **5. Non-liability**

MEREBO Messe Marketing assumes no liability for exhibition items or display material and something like that just as consequential damages. MEREBO Messe Marketing moreover excludes all liability for disadvantages and damages suffered by exhibitors as the result of incorrect catalogue entries and additional services. This does not affect liability on the basis of wilful or gross negligent misconduct. Any liability for ensuring unhindered setting up and taking down of stands is excluded. Non-liability is valid for damage direct or indirect independent of legal ground. Non-liability refers to material, property and personal damage, i. e. damage to body and life. It is valid for the exhibitor as well as for any other persons participating in the exhibition. The non-liability mentioned above is also valid for the other exemptions and limitations of liability of these terms of exhibition which will be effective without restrictions.

### **6. Warranty**

Complaints about any deficiencies in the stand or exhibition area are to be made in writing to MEREBO Messe Marketing immediately on taking over the stand, and at the latest on the last day for setting up stands, so that MEREBO Messe Marketing can remedy such deficiencies. Subsequent complaints cannot be considered, and cannot lead to claims against MEREBO Messe Marketing.

### **7. Legal venue**

The legal venue and place of fulfilment for contractual payments is Hamburg/Germany. Federal German law shall apply to any disputes arising from the contract. This translation is intended only for guidance and information. To the best of our knowledge and belief it is a faithful representation of the German original; however, in the event of divergence between the English and the German text, the German takes precedence.